

Aluminium Profile



ONEUP

ALUMINIUM PROFILE 17.3mm x 14.5mm x INT 12.3mm



Oneup is a surface mount or flangless recessed aluminium profile that comes complete with an easy cut opal diffuser as standard.

Oneup is suitable for single rows of low to high output tapes, CCT, RGB, RGBW, RGB+W+WW and some IP rated tapes.

Standard in 2m, 2.5m and 3m lengths lengths in an anodised finish, with custom colour options available.

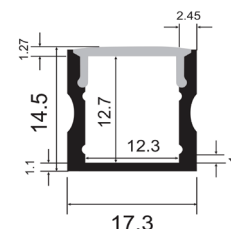

*We can custom colour this profile to suit your project. Please contact us for a quote.

2m, 2.5m and 3m lengths of this product are available ex-stock.

ORDER CODE	DESCRIPTION
ICL-ONEUP	ONEUP ALUMINIUM PROFILE SURFACE MOUNT
ICL-END-ONEUP	ONEUP END CAPS
ICL-MOUNT-STD	ONEUP MOUNTING CLIPS

Industrial Commercial
Lighting is a New Zealand
owned and operated
lighting solutions company
based in the South Island

We provide industrial, commercial,
architectural, sports, design and
consulting lighting services.

Contact us for more information, or
to discuss how we can assist you with
a tailored lighting solution.

Phone **03 385 2291**
Email **contact@iclighting.co.nz**

www.iclighting.co.nz

